

NOTE:
Sill sealing method for flange
end type drainage system

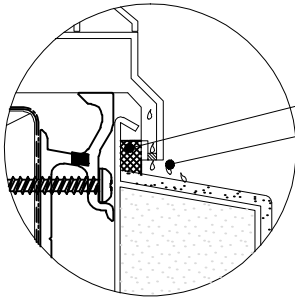

Continuous seal
Keep drainage passage clear

**APPROVED PROPRIETARY BREATHER TYPE
BUILDING WRAP MUST BE CONTINUOUS
AROUND FRAMING AND TAPED AT
CORNERS AND ALONG SILL WITH
WATERPROOF MEMBRANE TAPE BY
BUILDER**

MS SEALANT

ONLY REQUIRED IF SPECIFIED

GRAPHEX PVC SILL SECTION

CAVITY BATTEN

**ALL WINDOWS MUST BE NOGGED
UNDER SILL TRIMMER**

**NOTE: A 5° SLOPED SILL TRIMMER MUST BE USED IF THE BACK OF THE
GLAZING CHANNEL IS POSITIONED BACK PAST THE LINE OF WALL FRAME**

08 RECESSED JOINERY SILL

PSL NUPLEX

OCTOBER 2009